

EXHAUST FAN

OPERATING INSTRUCTIONS

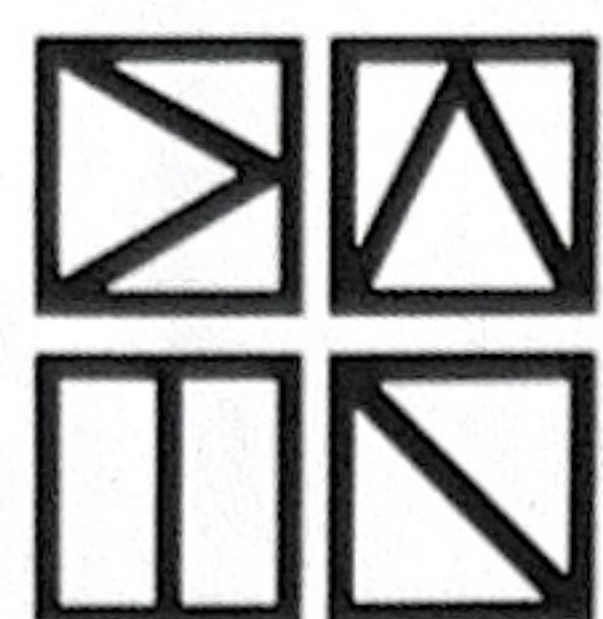

**DWELL
AIR**

**VENTILATION FAN
(INLINE FAN)**

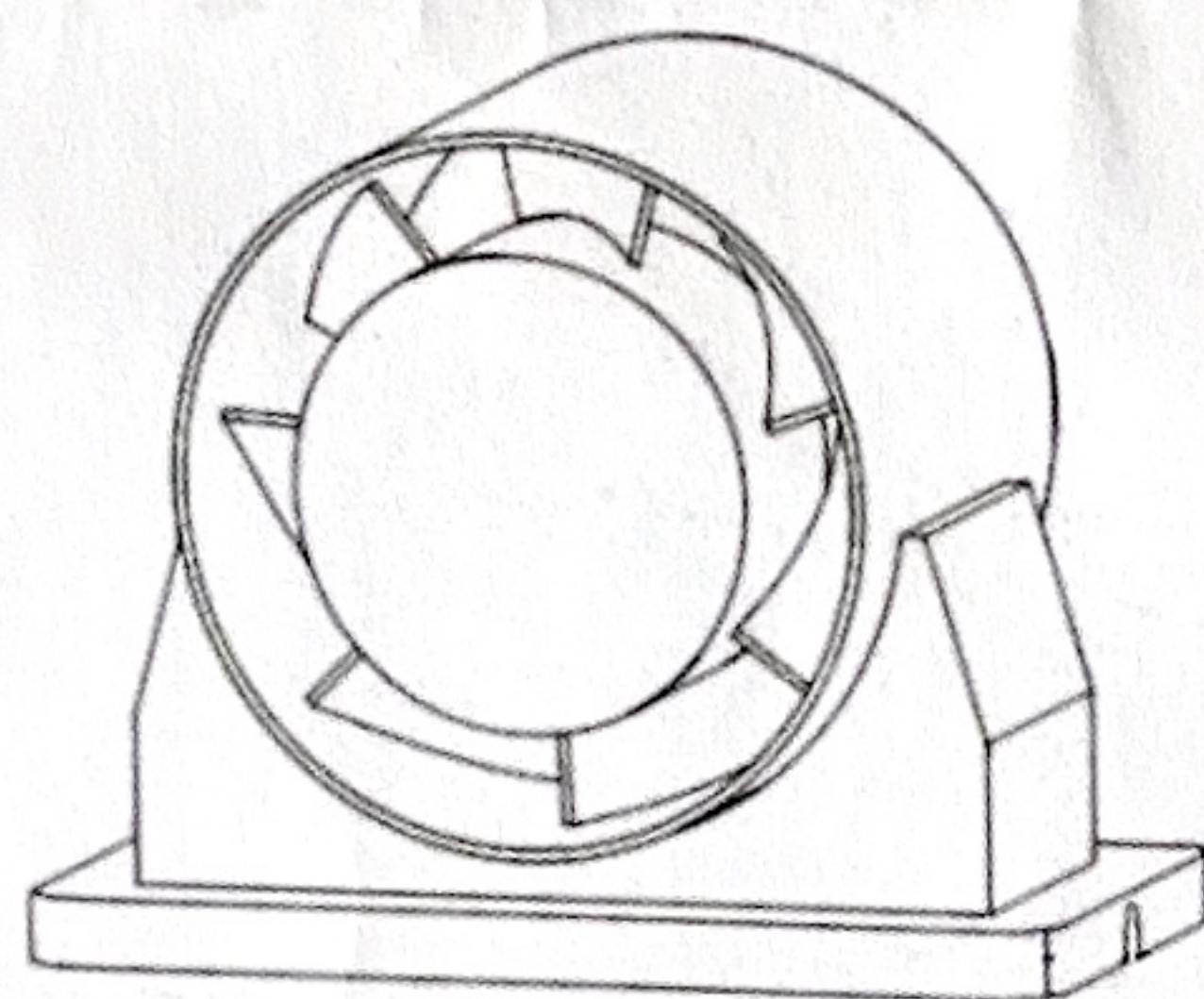

**DAIF 100
DAIF 150**

SPECIFICATIONS

Model	SIZE	Rated Voltage	Rated Frequency	Rated Power	Air Volume	Noise
DAIF 100	Φ 100	220/240V	50/60Hz	14W	80m ³ /h	33dB
DAIF 125	Φ 120	220/240V	50/60Hz	17W	150m ³ /h	35dB
DAIF 150	Φ 150	220/240V	50/60Hz	22W	250m ³ /h	37dB

PRODUCT DIMENSION

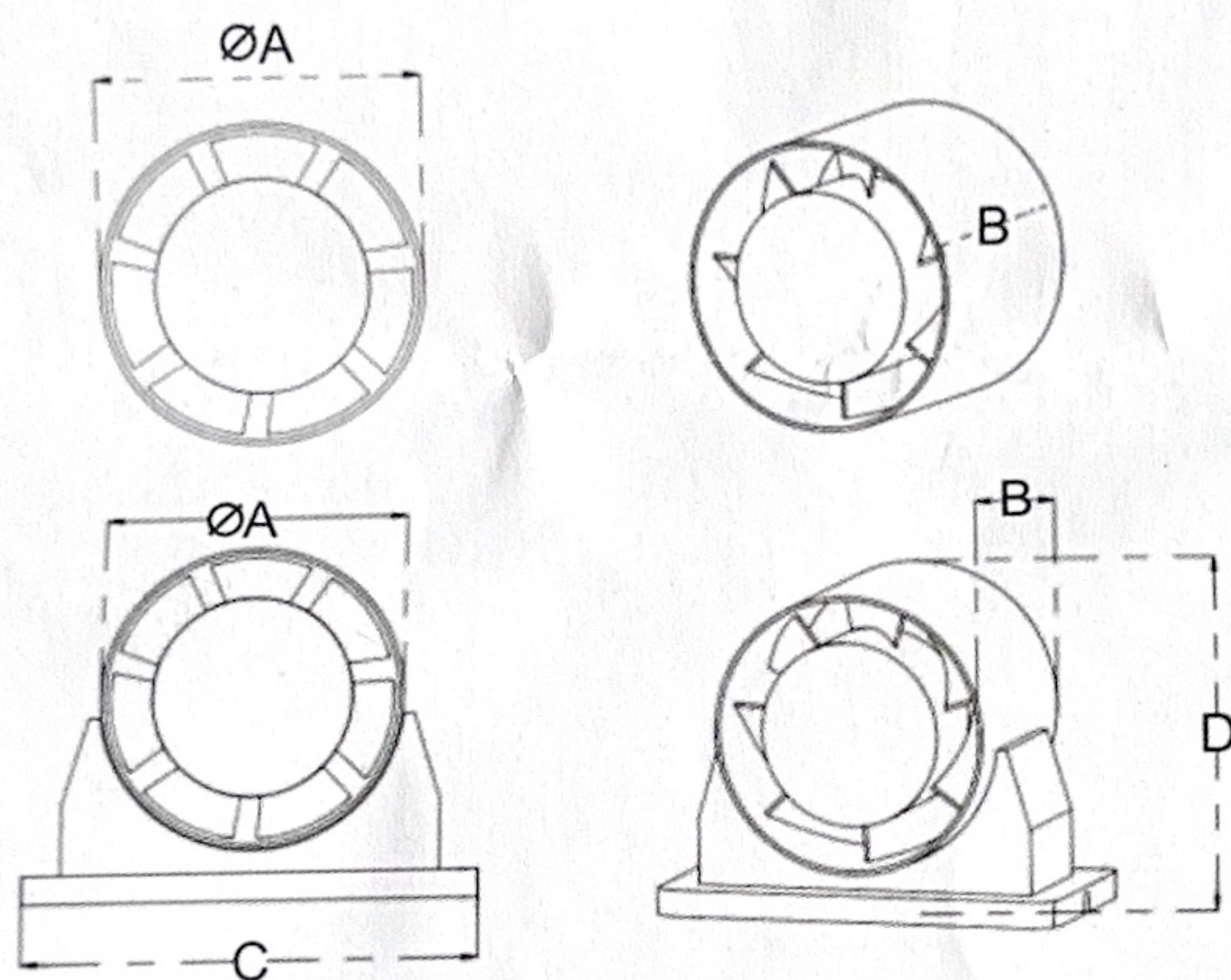

MODEL	A (mm)	B (mm)	C (mm)	D (mm)
DAIF 100	Ø97.8	87	150	114
DAIF 125	Ø 117	102	180	136
DAIF 150	Ø 146	128	222.5	167.2

WIRING DIAGRAM

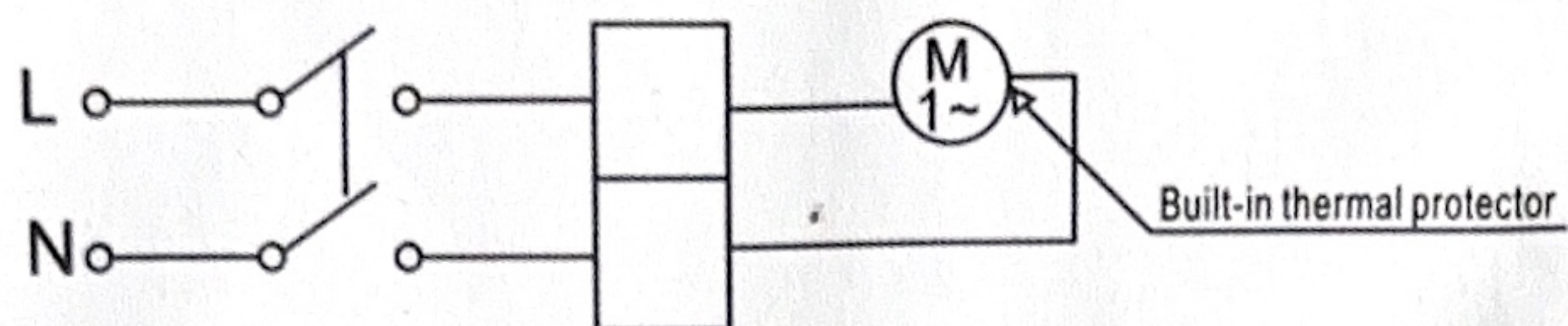

APPLICATION

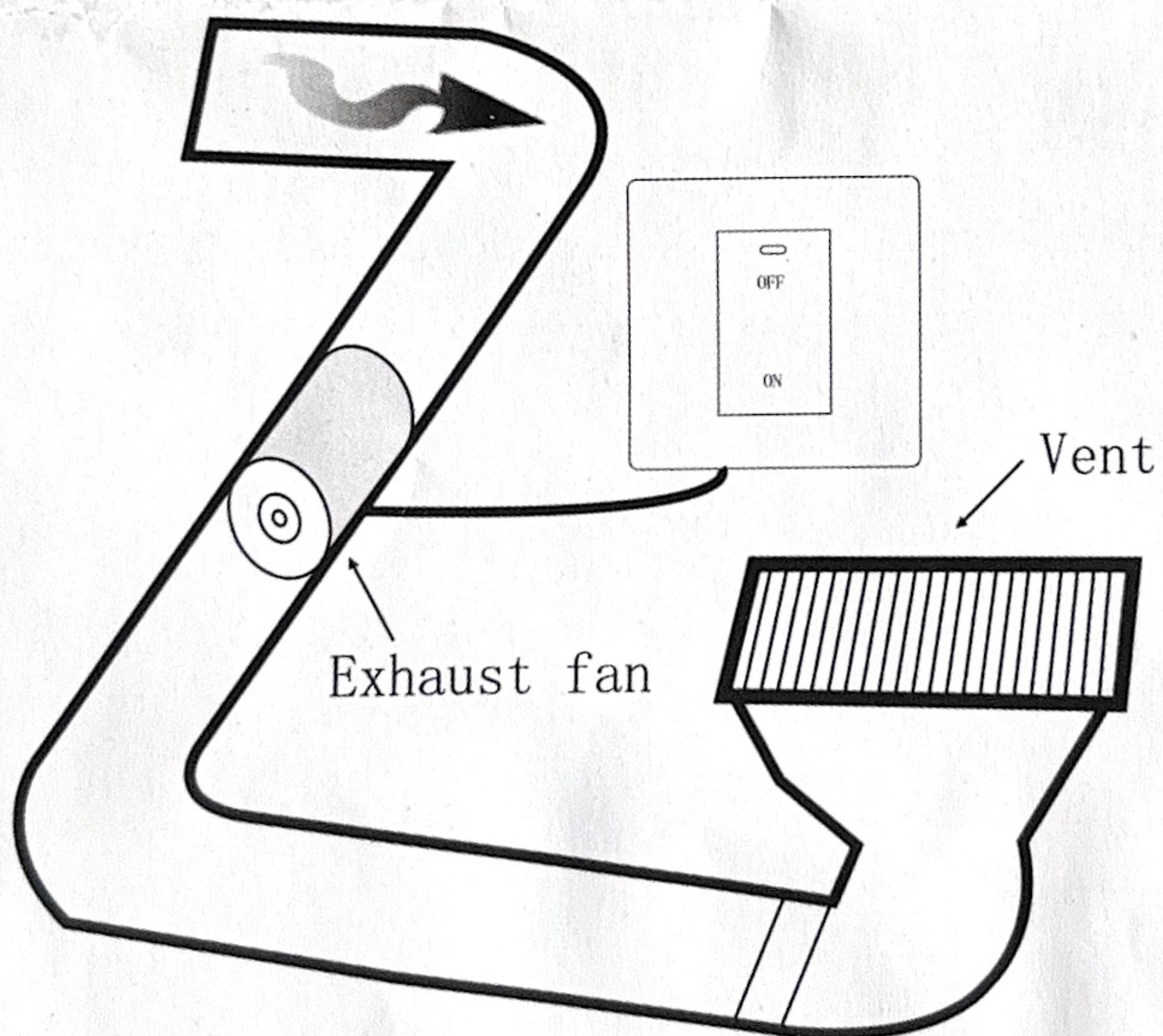
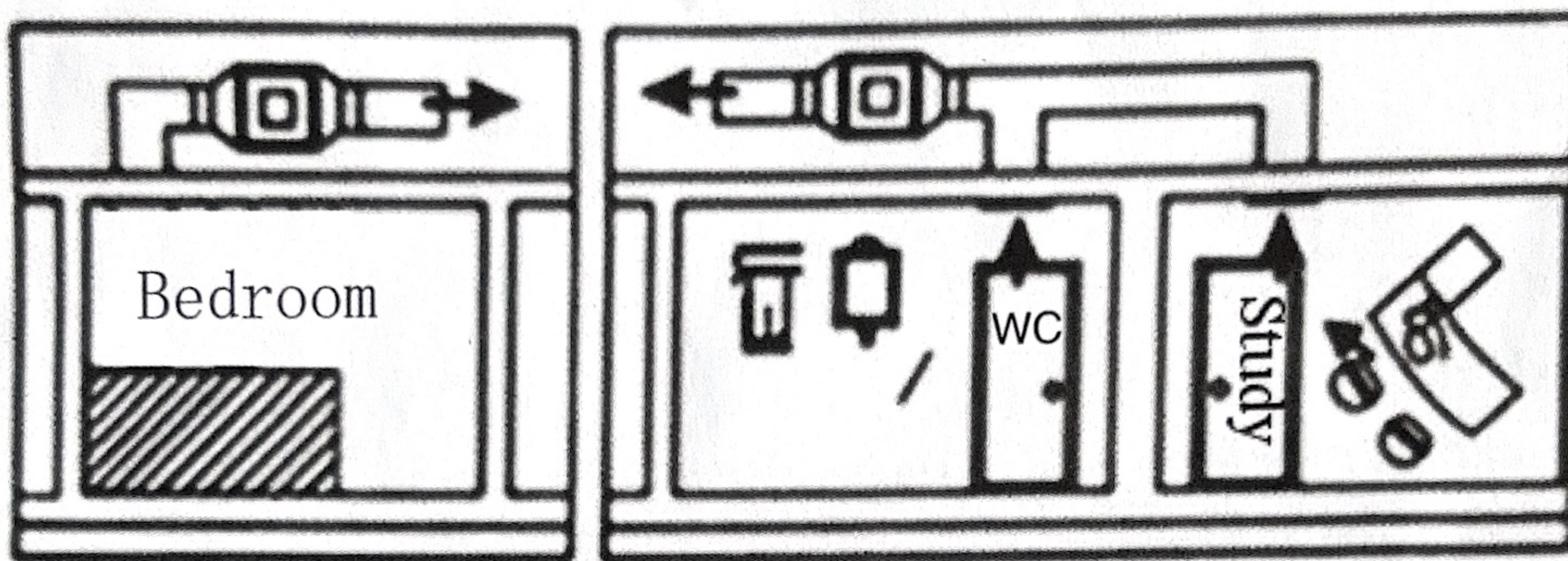

Start

*Please confirm before start:

*Wiring is correct, and the equipment's wire connection is firm.

*Electrical safety device is connected correctly and adjusted to proper position.

*The wire and wire joints are insulative and water resistant.

*The vane wheel's rotation is right.

*There is no abnormal vibration.

*If the wire installation device trips, please cut off the power supply.

Before start later, please check all installation.

Maintenance

*Before maintenance of the blower, though the blower's switch is off, please cut off the main power supply in case of others' delivery of electricity by mistake.

*Check the equipment and its working environment regularly, in case of too much dust stocked on vane wheel, protective screening, which brings danger or cause the product's working life.

*Please be greatly careful while washing, in case of destroying vane wheel's balance.