

材质：80克双胶纸

145 mm

USAGE METHOD

1. Press the air change button on the remote control to enter the air change mode of the machine. When it needs to stop running, press the standby button on the remote control;
2. Press the 24-hour air change button on the remote control to enter the 24-hour air change mode. After 5 minutes of running the air change mode, the machine automatically enters the standby mode, which is a cycle of 25 minutes. If it needs to stop running, press the standby button on the remote control;
3. Press the hair dryer button on the remote control to enter the hair dryer mode. If you need to stop running, press the standby button on the remote control;
4. Press the heating button on the remote control to enter the heating mode operation of the machine (automatic standby mode after continuous operation for 2 hours). If it is necessary to stop operation, press the standby button on the remote control to delay the fan operation for 30 seconds to cool the heater;
5. Press the drying button on the remote control to enter the drying mode. After running the warm air mode for 25 minutes, the machine automatically enters the ventilation mode for 5 minutes, which is a cycle (about two hours after four cycles, the machine automatically enters the standby mode). If it needs to stop running, press the standby button on the remote control to delay the fan from running for 30 seconds to cool the heater;
6. Press the sweeping button on the remote control to operate in the blowing, heating, and drying modes. The wind vane on the body starts to swing. When it needs to stop running, press the sweeping button on the remote control again;
7. Press the lighting button on the remote control, and the light on the body will light up, which can be used as auxiliary lighting for night or dark environments. When stopping operation, press the lighting button on the remote control again.

NOTE

1. This product needs to be installed in a place that can withstand the weight of this product;
2. Poor installation can cause abnormal noise, please assemble it properly;
3. In order to prevent the condensation water from flowing back inside the exhaust pipe, the pipeline leading to the outside must be kept sloping downwards;
4. After installation, the distance between the outer cover and the ground shall not be less than 2.3 meters;
5. It cannot be installed directly above the water heater or at a temperature above 40 degrees;
6. It is strictly prohibited to change the rated usage characteristics of the product;
7. When ceiling mounted, the opening of the host should be downward and kept horizontal;
8. To avoid overheating of the product, do not cover the air outlet;
9. The heater should not be directly placed under the power socket; The installation should ensure that people in the bathtub and shower area cannot touch the switches and other controllers;
10. It is strictly prohibited to use switches or any other devices that may automatically turn on the power supply for this product, otherwise it may cause damage to the product and pose a fire hazard;
11. It is strictly prohibited to install this product near curtains or other flammable materials to avoid danger;
12. This product must be installed in an inaccessible area within the shower area;
13. Do not install this product in the wardrobe;
14. It is strictly prohibited to directly expose this product and remote control to the shower.
15. Instruments must be installed and wired in accordance with national wiring regulations. Between fixed wiring and the host of this product, a device with an electric shock distance of all poles under overvoltage level III conditions must be installed to disconnect the power supply (specifications must not be less than 250V~20A), and a leakage protection switch (leakage current below 30mA).
16. The light source inside this lamp should be replaced by the manufacturer or its service agent or someone with similar qualifications.
17. The external flexible cable or flexible cable of this lamp cannot be replaced. If the flexible cable is damaged, the lamp should be reported



INDOOR HEATER

COMFORT 3 IN 1

Installation and Maintenance Instructions

THESE INSTRUCTIONS MUST BE READ FULLY BEFORE COMMENCING INSTALLATION

SPECIFICATIONS

Model	Volt (V)	Freq (Hz)	Input Power (W)	Light Power (W)	Air Volume (m³/min)	Noise dB(A)
COMFORT 3 IN 1	220	50	2100	1.5W (5×0.3W LED)	2.8	45

Table 1

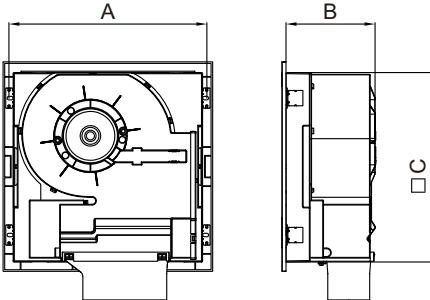
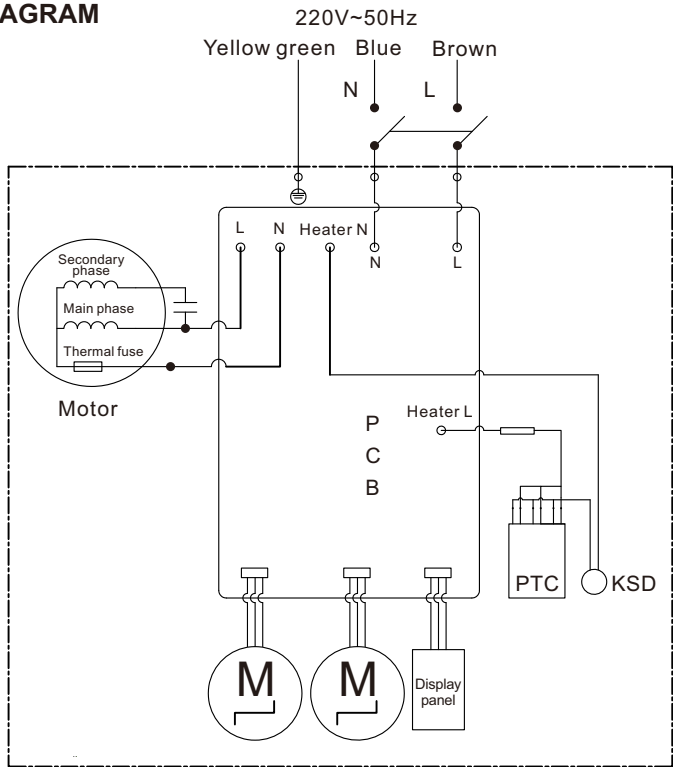

Table 2

WIRING DIAGRAM



(Note: Non electrical professionals are prohibited from disassembling and repairing without authorization)

INSTALLATION

Ordinary ceiling installation method  
Installation with ventilation pipe

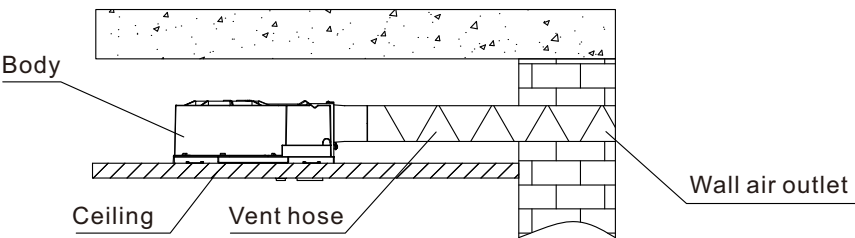

1. Remove the panel from the body.
2. Remove the four mounting clips from the body.



3. Flip over the four installation clips and install them onto the machine body as shown in the figure.
4. Install dimensions on the ceiling grid 272-275mm wooden frame holes.

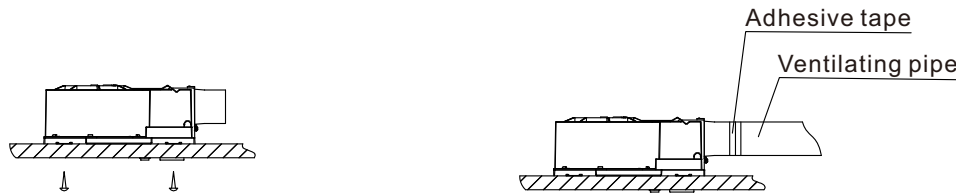

5. Insert the body into the wooden frame and use wooden tapping screws (4 pieces) Fix the body.
6. Connect the exhaust duct to the body air outlet and do not use it dry Tape sealing.

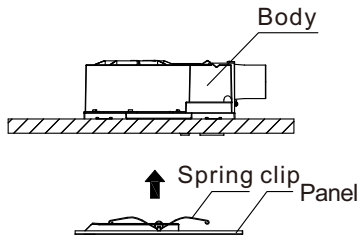

7. Professional electricians should connect the wires according to the wiring diagram and wiring markings, and then plug the excessively long power cord into the ceiling.

8. Reinstall the removed panel onto the body (grip the spring clip with both hands and push it into the long hole of the body), and then turn on the power.

INTEGRATED CEILING INSTALLATION METHOD

Installation with ventilation pipe

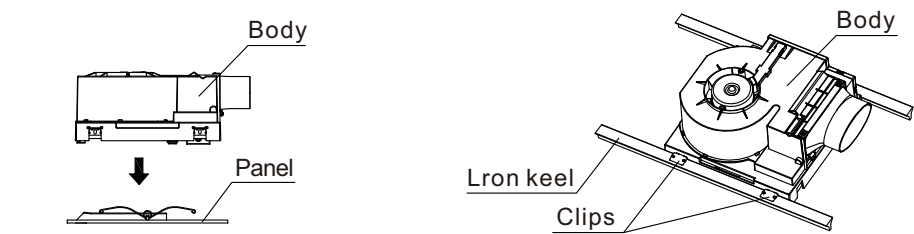
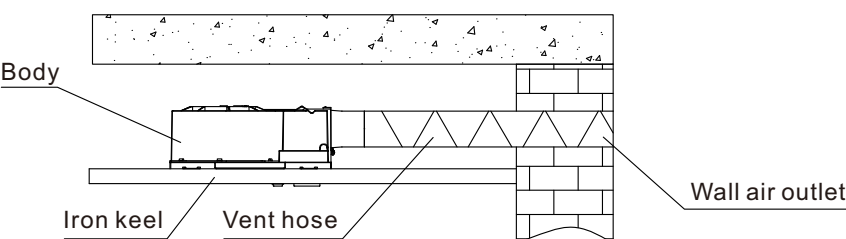

1. Remove the panel from the body.
2. Place the machine body on the iron keel (ensure that all four mounting clips are stable).

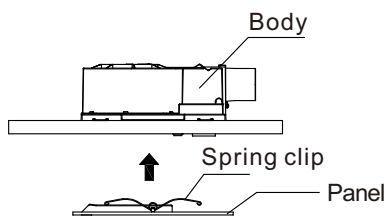

3. Professional electricians should connect the wires according to the wiring diagram and wiring markings, and then plug the excessively long power cord into the ceiling.
4. Reinstall the removed panel onto the body (grip the spring clip with both hands and push it into the long hole of the body), and then Turn on the power.

REMOTE PAIRING METHOD

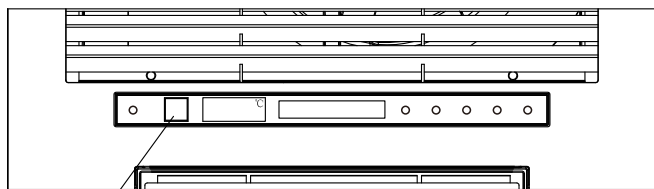

1. Press and hold for 5 -10 seconds after powering on

Within 10 seconds of powering on the body, press and hold the "On/Off" button on the body panel for 5 seconds, and the buzzer on the body will emit a "drip" sound After one sound, click the lighting button on the remote control twice, and the buzzer will sound twice to indicate successful pairing

2. Click twice after the buzzer beeps once

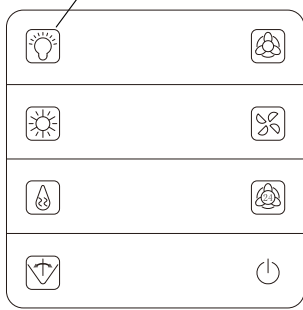

PANEL DISPLAY BOARD INSTRUCTIONS AND USAGE INTRODUCTION

1. After powering on, all lights on the panel display board remain on for a long time, and after 5 seconds, they automatically turn off to enter standby mode. The standby indicator light is red, other function indicators are blue, the temperature display light is white, and the temperature display light and standby indicator light remain on;
2. The functional order of the "On/Off" button is ventilation, 24-hour ventilation, blowing, heating, drying, and standby